



DuraCam® II Removable Core Cam Lock

Medeco's® DuraCam series of cam locks with the removable core function is the ultimate security solution for the gaming industry. With a 1/8" thick key cut on the broad side instead of on top, DuraCam II offers one of the strongest keys in the market guaranteed against breakage. Designed specifically to meet the rigorous demands of slot collections and service, DuraCam removable core provides one of the strongest keys in the industry with a quick change plug, to keep your equipment up and running. No other lock manufacturer in gaming can compare with Medeco's 30 year history of security and reliability. The strongest key, removable core, combined with patented key programs that prevent the unauthorized duplication of keys make Medeco the obvious choice for gaming professionals. Keyed alike or different, Medeco's DuraCam series cam locks offer a complete line of sizes and functions to meet your specific gaming needs.



Medeco's unique elevate and rotate pin tumbler design provides double locking action, making cylinders virtually pick proof. All Medeco Biaxial keys and cylinders are protected under patent, trademark, and copyright laws. Biaxial keys may only be duplicated by Medeco or by an authorized Medeco Service Center, and only at your request.

Benefits:

- ▼ DuraCam offers one of the strongest keys in the gaming industry, guaranteed against breakage.
- ▼ Removable core function allows minimal down time during lock change out due to lost or stolen keys.
- ▼ All Medeco cylinders are constructed of durable machined brass components, designed to last the life of your equipment.
- ▼ Unique elevating and rotating tumbler pin system is virtually pick proof.
- ▼ Patented Biaxial keys may only be duplicated by Medeco or authorized Medeco Service Center, and only at your request.
- ▼ Medeco cam locks are completely serviceable, and can be re-keyed in case of lost or stolen keys
- ▼ Locks can be keyed alike or different, depending on your specific needs.
- ▼ Available in standard lengths, key retained, two flat, and various rotations.

Applications:

Medeco's DuraCam series of removable core cam locks are specifically designed for 3/4" diameter slot lock and other casino equipment applications where key breakage and quick change are the major lock related issue.

Warranty:

Warranted for two years against manufacturer's defects. See Medeco limited Warranty for full details.

Technical Information:

Four models available. Standard sizes include 5/8", 7/8", and 1 1/8". Two flat models available, key retained. Clockwise or counterclockwise rotation, 90° or 180°. Keyed alike or keyed different.

Finishes:

26 Satin chrome finish is standard. Other finishes available, depending on volume.

Ordering Instructions

DuraCam® II removable core gaming locks are only sold through authorized Medeco gaming service centers and distributors. DuraCam II removable core gaming locks are key retaining only. Medeco 60 series cam locks are sold less keys. Specify number of keys required under separate line item. Cams sold separately, reference cams section to select proper cam type.

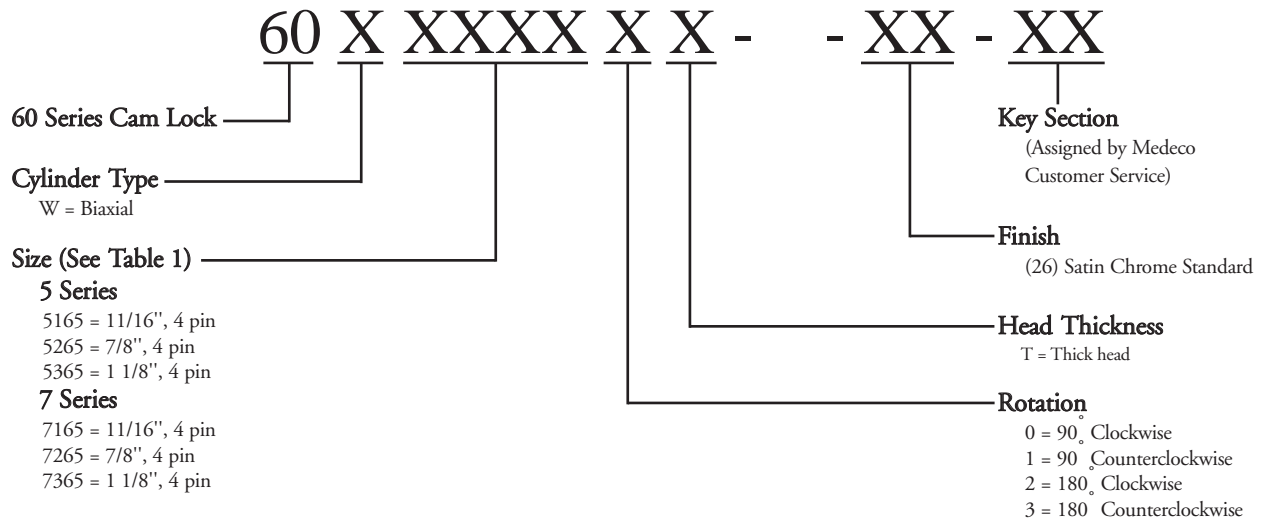

What is the difference between 5 and 7 Series locks?

The 7 Series is the latest generation of Removable Core Cam Locks.

The 5 Series locks require a different core for clockwise or counterclockwise applications. If you are adding to an existing system that uses 5 Series locks, we recommend that you continue to order 5 Series product.

The 7 Series locks use the same core for all applications. If you are ordering product for a new system or application, we recommend the 7 Series. You will never have to worry about selecting the proper core for an application, and you will only have to stock one type of core.

When ordering a complete 5 or 7 Series Cam Lock, you must still specify the rotation so that the actuators and stop washers will be assembled properly. However, all 7 Series locks will use the same replacement core.

Exploded View

DURACAM II REMOVABLE CORE

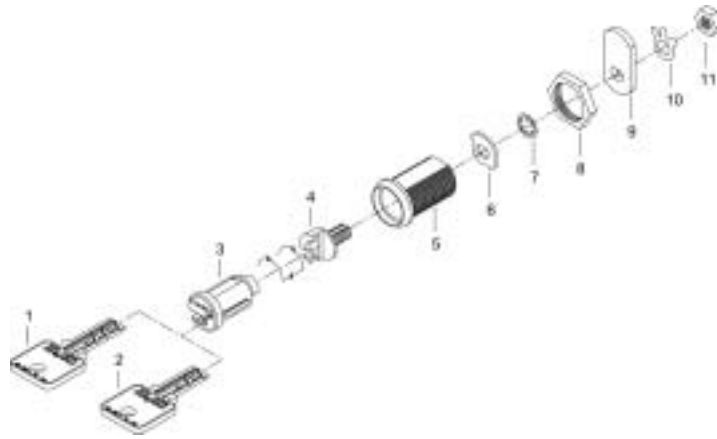

ITEM	DESCRIPTION
1	Operating Key (for operating lock)
2	Control Key (for removing core)
3	Plug Assembly
4	Cam Adaptor
5	Shell
6	Stop
7	Retainer
8	3/4" Nut
9	Cam
10	Tab Washer
11	9/32" Nut

Technical Drawings

DURACAM II REMOVABLE CORE GAMING LOCK SIZES

C = Body Length

E = Head Diameter

D = Head Length

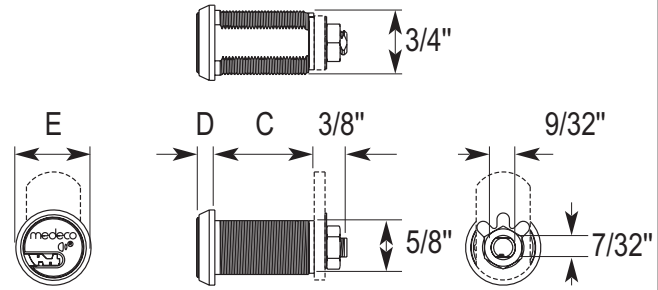

Table 1

Size Code	# of Pins	C	D	E
5165	4	11/16"	5/8"	1"
5265	4	7/8"	7/16"	1"
5365	4	1 1/8"	3/16"	7/8"
7165	4	11/16"	5/8"	1"
7265	4	7/8"	7/16"	1"
7365	4	1 1/8"	3/16"	7/8"

Standard sizes described. Consult Medeco® customer service for variations not described.

DURACAM II REMOVABLE CORE GAMING LOCK MOUNTING DETAIL AND ROTATION

Double D Mounting

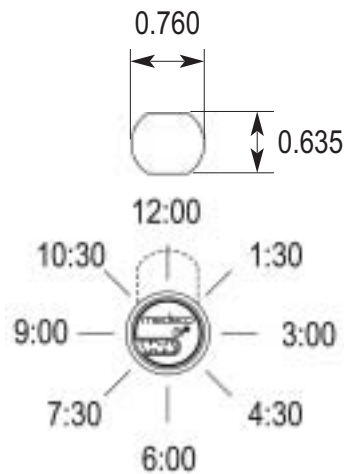

Cylinder is shown in locked position

Table 2

Rotation	Direction	Travel	From	To
0	Clockwise	90°	9:00	12:00
1	Counterclockwise	90°	9:00	6:00
2	Clockwise	180°	9:00	3:00
3	Counterclockwise	180°	9:00	3:00

Set-Up and Service Information for the DuraCam II

With the DuraCam II removable core cam lock product line, Medeco is able to offer some unique features beyond the ability to provide instantaneous, secure key changes, that really add value to the professional gaming end user.

Set-Up Core Program

During the installation of a new bank of slot machines, the coordination of the base and machine placement, electrical work, and lock installation is critical, and one of the easiest times to lose a key. Medeco offers a set-up core for the DuraCam II so that the risk and liability of a lost key are minimized. Set-up cores come in a three pin, unfinished plug with a vertical keyway, or a plastic dummy plug; which are easily recognizable from the standard horizontal keyway DuraCam II plugs. Set-up cores can be installed with the locks by the base and machine builders at their locations, thereby providing a way to keep the doors shut during transition but without compromising your key security. After installation of the machines is complete on the casino floor, and it is time to install locks, all that is required is five seconds to change out the set-up plug for the DuraCam II plug. The three pin set up cores can be returned to your Medeco Service Center once the installation is complete. This process can save hours of set up time during lock installation and valuable start-up costs.

Part #	Description
66-294435-	Three Pin Set-Up Core, Clockwise Function (5 series only)
66-299435-	Three Pin Set-Up Core, Counter Clockwise Function (5 series only)
CP-285160	Plastic Set-Up Core

Service Core Program

Medeco also offers service cores for times when machines are either down for maintenance on the floor, or need to be taken off the floor for repair, but still need security. Service cores are four pin, vertical keyway plugs, and once again are easily recognizable from the standard horizontal keyway DuraCam II plugs. These plugs can be keyed alike or different depending on your security requirements, and can have any standard Medeco finish.

Part #	Description
66-297556-	Four Pin Removable Core Plug, Clockwise Function (5 series only)
66-296556-	Four Pin Removable Core Plug, Counter Clockwise Function (5 series only)